

ADJUSTABLE SPRING TINE ASSEMBLY

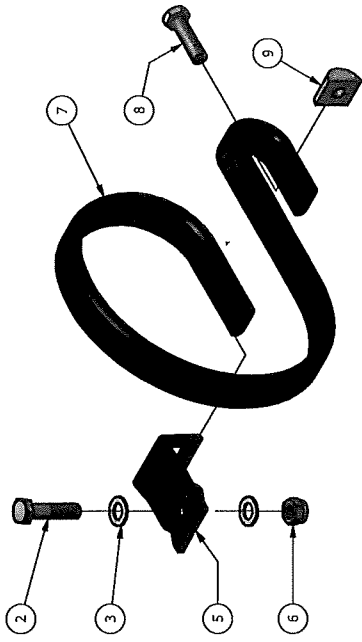

SPRING TINE & 'A' SHARE ASSEMBLY

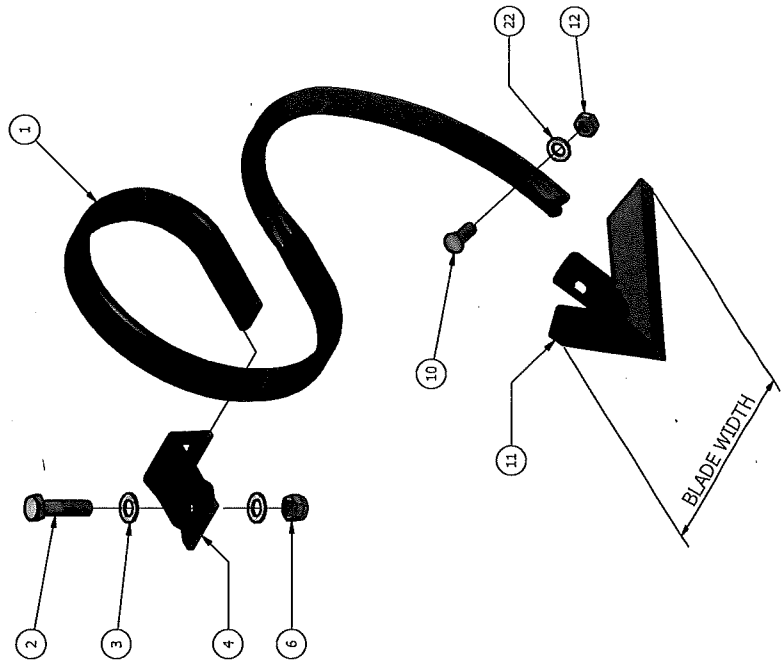

SLASH BLADES

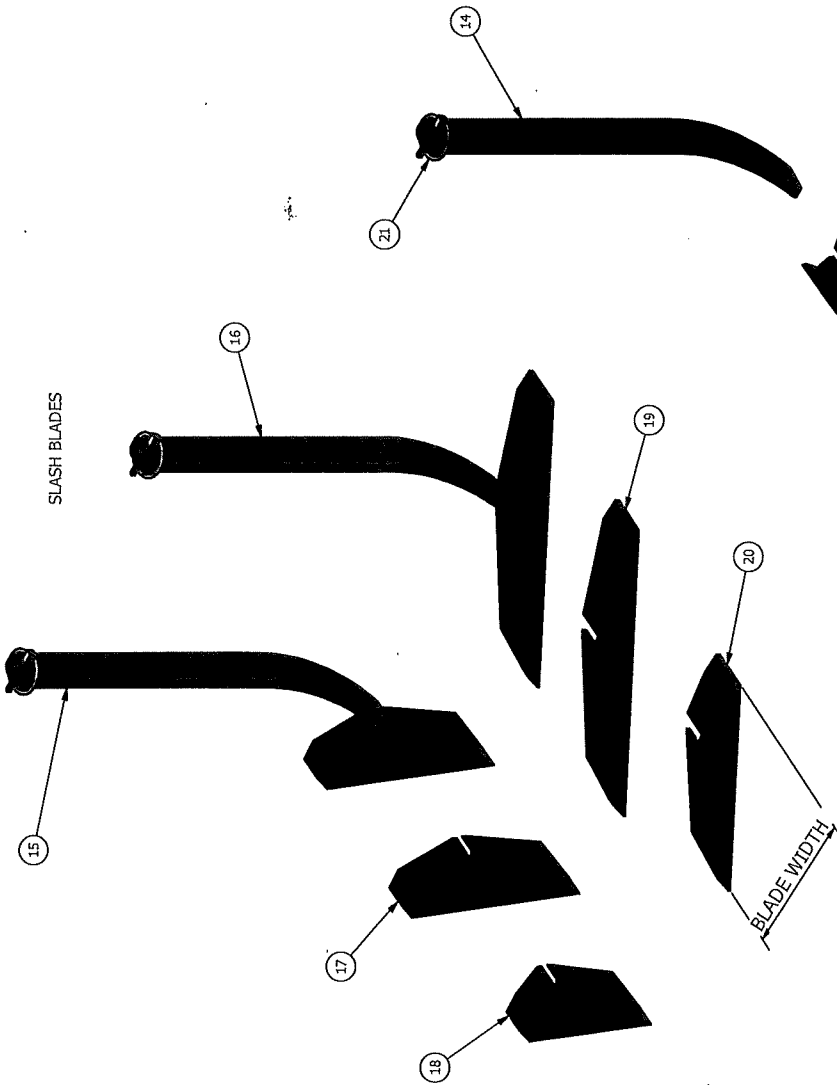

WELD ON FLAT 'A' BLADES

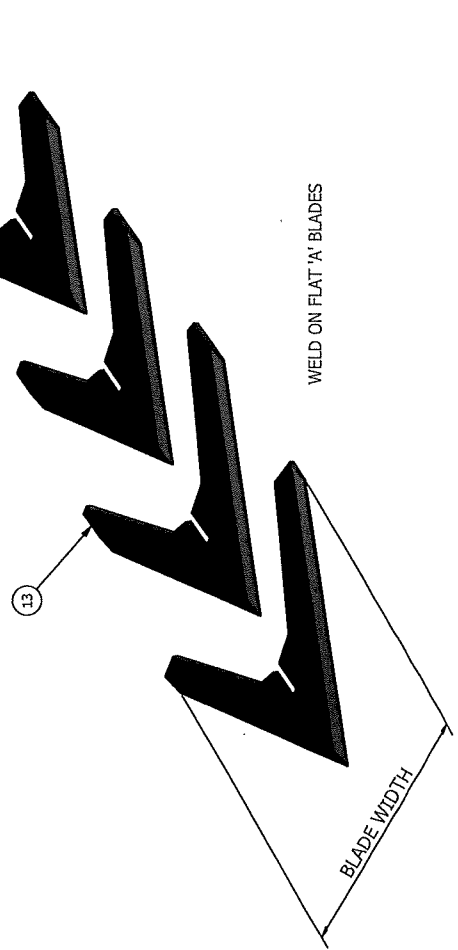

**ROBOCROP SPRING TINES, 'A' BLADES, SLASH BLADES
& WELD ON BLADES**

QUANTITY NOT SHOWN AS LIST IS FOR REFERENCE PURPOSES ONLY

ITEM No.	DESCRIPTION	PART No.	QUANTITY
1	SPRING TINE	5989	
2	M12x50 FINE THREAD BOLT BZP	7709	
3	M12 THIN WASHER BZP	7877	
4	SPRING TINE CLAMP	5992	
5	ADJUSTABLE SPRING TINE CLAMP	7515	
6	M12 FINE THREAD NYLOC NUT BZP	7487	
7	ADJUSTABLE SPRING TINE	7412	
8	M12x40 FINE THREAD BOLT BZP	8368	
9	ADJUSTABLE SPRING TINE NUT BLOCK	8365	
10	M10 SHARE BOLT	7812	
11	BOLT ON 'A' SHARES		
	100MM WIDE BLADE	6094	
	125MM WIDE BLADE	6871	
	150MM WIDE BLADE	7813	
	180MM WIDE BLADE	5990	
	200MM WIDE BLADE	7814	
	250MM WIDE BLADE	7815	
12	M10 HEX. NUT BZP	1150	
13	WELD ON FLAT 'A' SHARES		
	100MM WIDE BLADE	7648	
	120MM WIDE BLADE	7905	
	160MM WIDE BLADE	7619	
	180MM WIDE BLADE	7768	
	200MM WIDE BLADE	7741	
	220MM WIDE BLADE	7767	
	250MM WIDE BLADE	7551	
14	BLADE LEG	7552	
15	COMPLETE R/H SLASH BLADE LEG 180MM	7750	
	COMPLETE R/H SLASH BLADE LEG 130MM	8093	
16	COMPLETE L/H SLASH BLADE LEG 180MM	7749	
	COMPLETE L/H SLASH BLADE LEG 130MM	8094	
17	WELD ON 180MM R/H SLASH BLADE	7745	
18	WELD ON 130MM R/H SLASH BLADE	8091	
19	WELD ON 180MM L/H SLASH BLADE	7744	
20	WELD ON 130MM L/H SLASH BLADE	8092	
21	RETAINING PIN	10557	
22	M10 FLAT WASHER BZP		

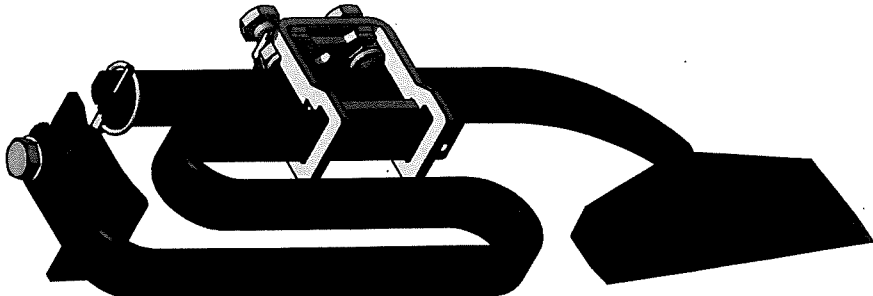
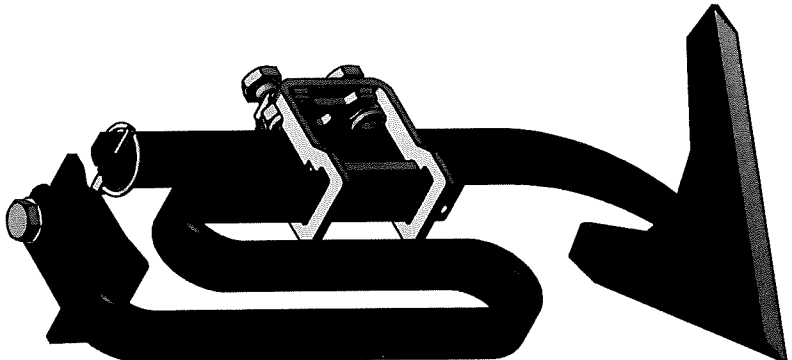
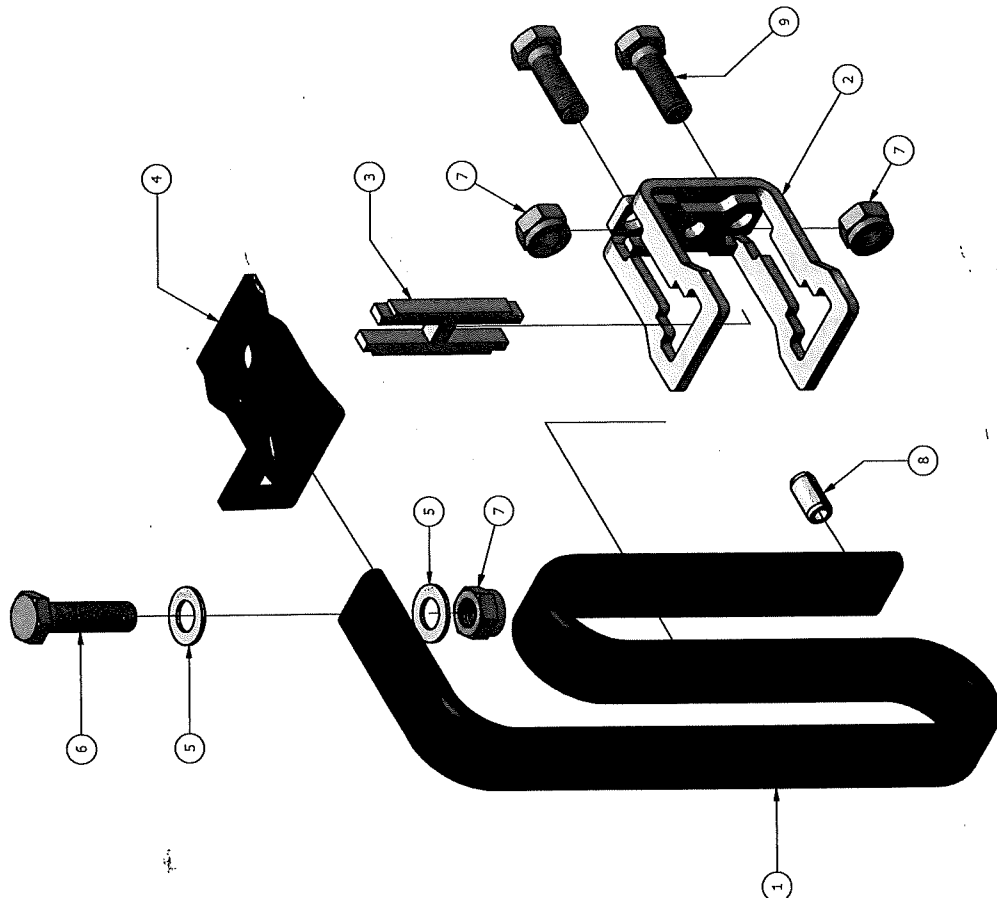

ROBOCROP COMPACT SPRING TINE ASSEMBLY

ITEM No.	DESCRIPTION	PART No.	QUANTITY
1	COMPACT SPRING TINE	9777	1
2	TINE CLAMP	10094	1
3	TINE CLAMP ROCKER BASE	10095	1
4	S-TINE CLAMP	5992	1
5	M12 THIN WASHER BZP		2
6	M12x45 FINE THREAD BOLT BZP		1
7	M12x1.5 NYLOC NUT BZP		3
8	SPRING PIN		1
9	M12x35 FINE THREAD BOLT BZP		2