

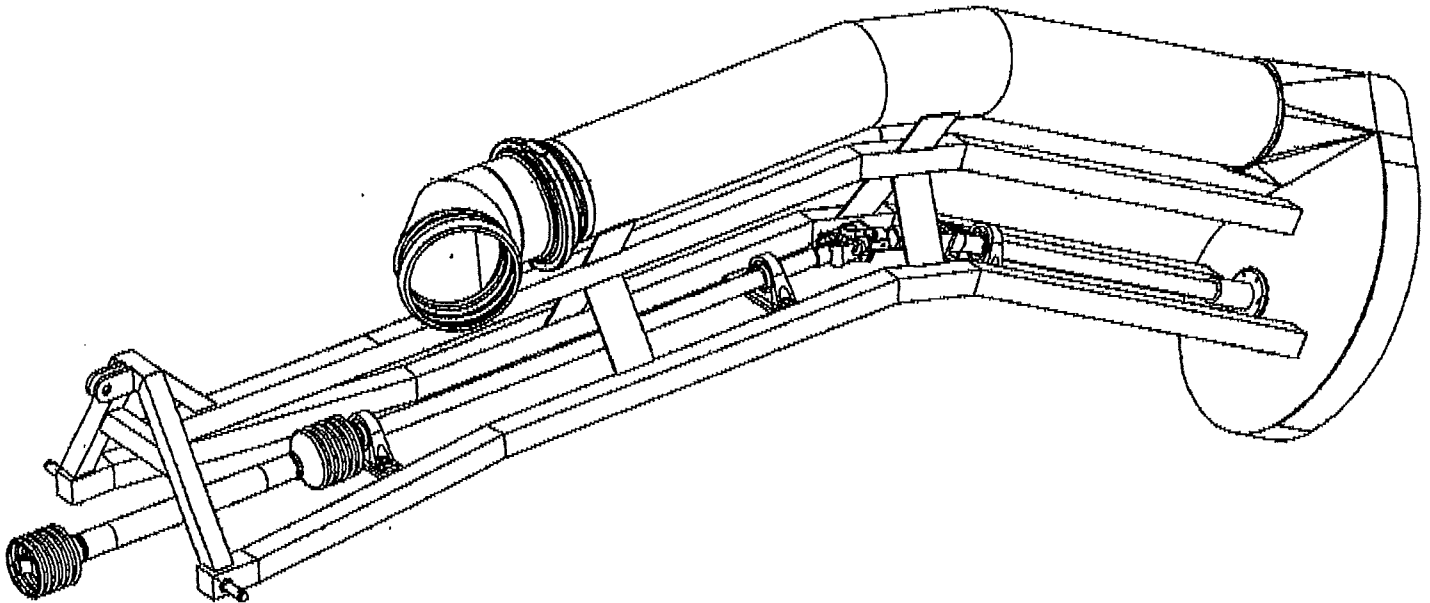

**CT6M-F**

SERIAL# \_\_\_\_\_



CT6M-F			
REF#	DESCRIPTION	QTY	PART NUMBER
1	Frame	1	MPU002733
2	Elbow 6" 45 Deg.	1	MFP01396
3	Lock, 6" Circle Ring	1	5PMP2123-02
4	Gasket, Rubber	1	5PMP1620-01
5	Impeller, 17"	1	MFP06033
6	Strainer, Intake	1	MPU002659
7	Plate, Outer Strainer Intake	1	MPU002600
8	Shaft, Rear 1-1/2"x4'-1-3/4"	1	MPU002616
9	Assembly, Double Joint	1	PUJ01088
10	Shaft, Front 1-1/2"x 5'-6"	1	MPU002617
11	Bearing, 1-1/2"	3	5BRGUCPL208-24
12	Holder, Flanged Marine Bearing	1	MPU002586
13	Bearing 1-1/2"x2"x6" Marine	1	5BRG1 1/2x2x6
14	Nut 1-1/4" LH	1	5NUT1 1/4-10LHBRZ
15	Key, Shaft	3	MFP02998
16	PTO, 1-1/2"x 1-3/8 (6) 2500		5UJT392667
16	PTO, 1-1/2"x 1-3/8 (6) 44		5UJT14004424

# CTM-F

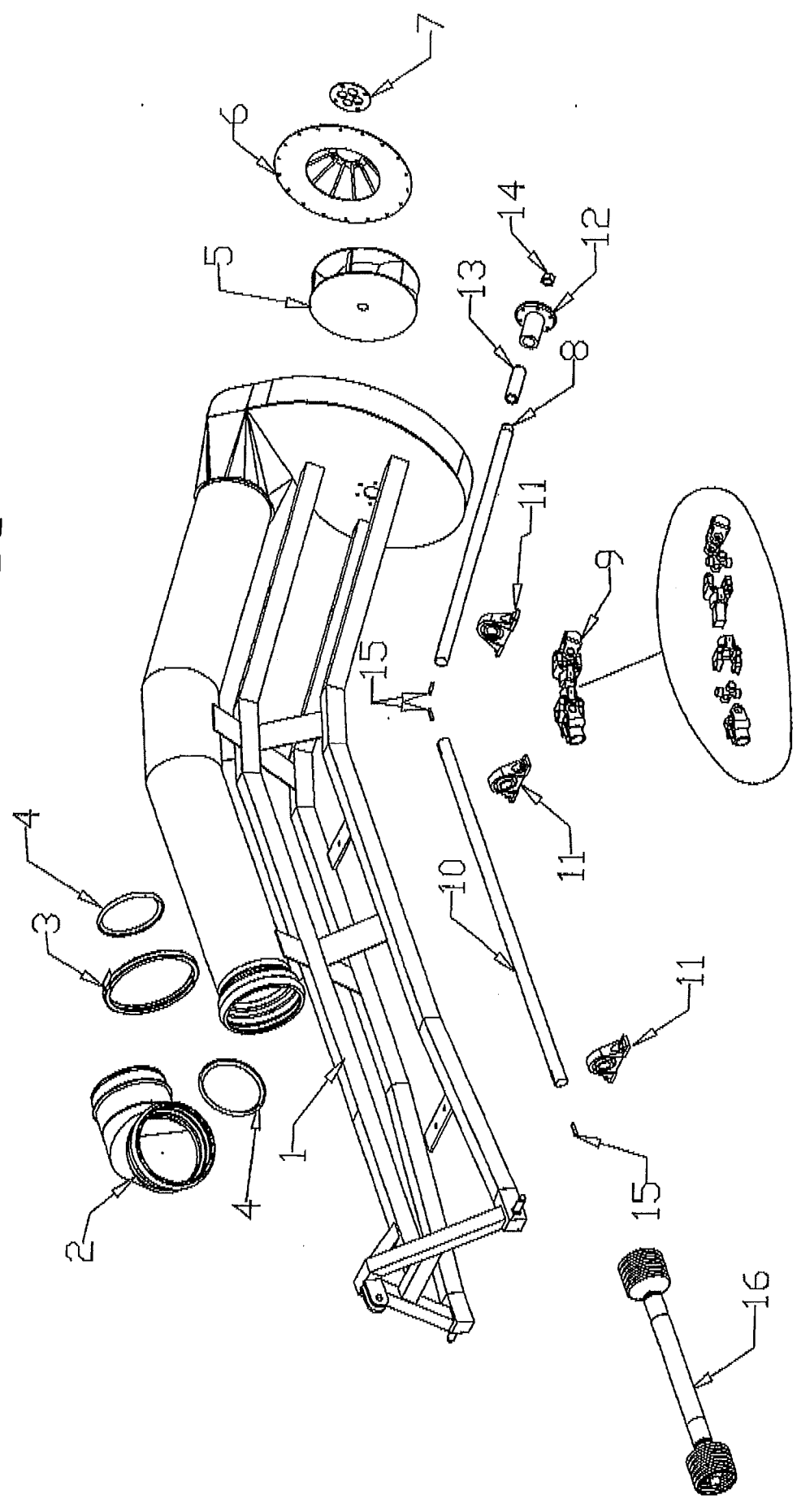

PUJ01989		
9A	Yoke / W Shaft	1 PUJ02004
9B	Yoke	2 5UJT8064424
9C	Universal Joint	2 5UJT2004400
9D	Yoke	1 5UJT3004400

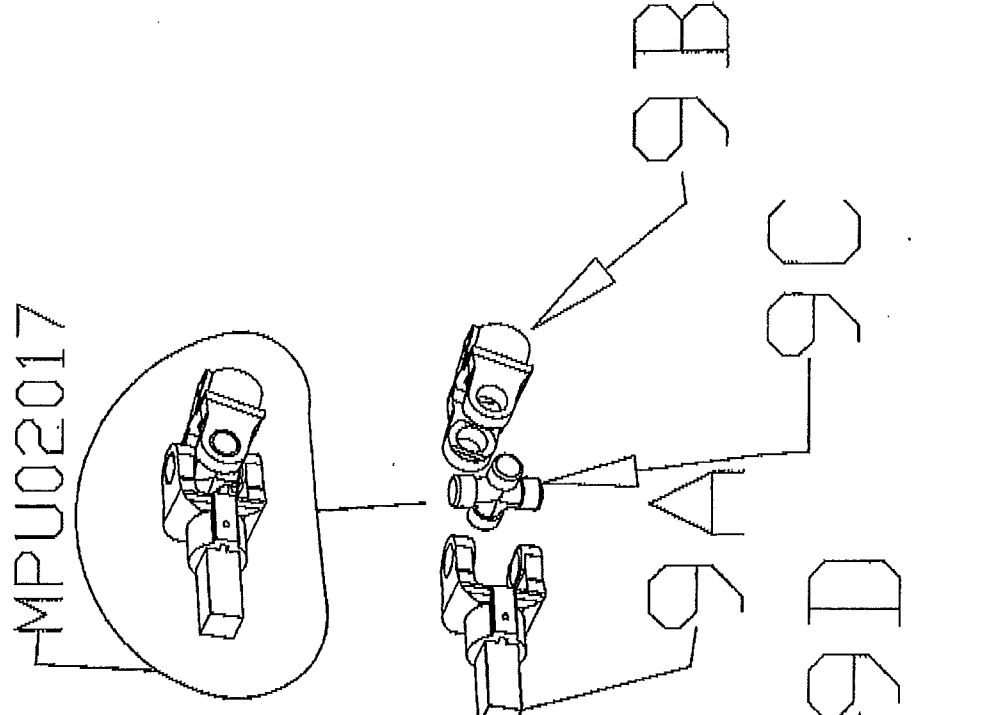
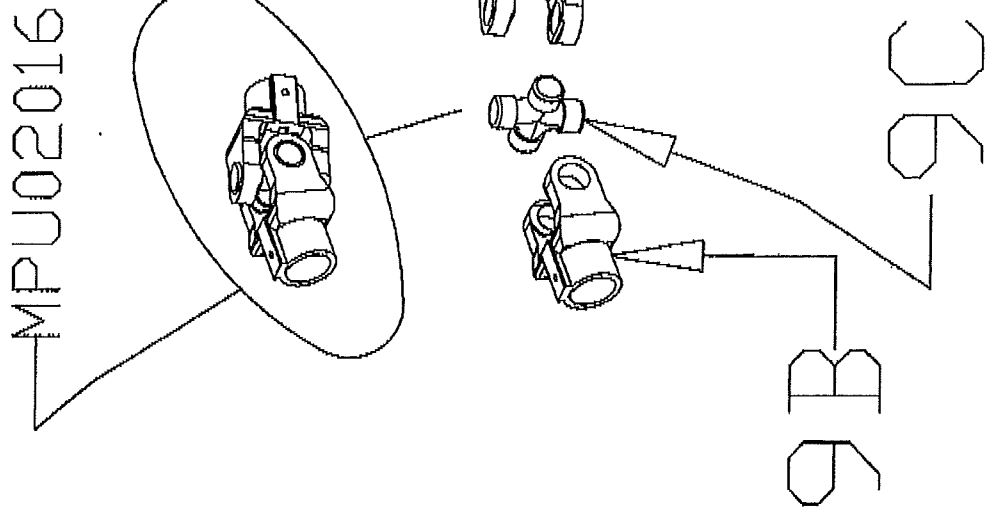

REF#	DESCRIPTION	QTY	PART NUMBER
12	Holder, Flanged Marine Bearing	1	MPU002586
12A	Bolt, 3/8"x 1-1/2" Plow	24	6BLTPL38112Z
12B	Washer 3/8" Flat	24	6WSHFLT38S
12C	Washer, 3/8" Lock	24	6WSHLOCK38S
12D	Nut, 3/8" Brs	24	6NUT38HXBRS

