

POCKET SPADES ASSEMBLY

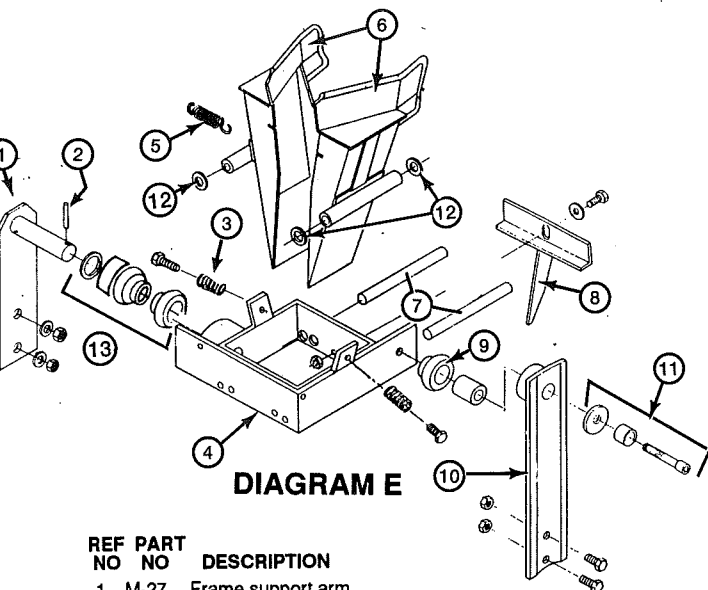

DIAGRAM E

REF NO	PART NO	DESCRIPTION
1	M-27	Frame support arm
2	M-97	Retaining pin for arm
3	M-98	Closer adjustment spring
4	M-26	Holder frame with bearing
5	M-31A	Spade spring
6	-----	Pair of spades - see number & sizes below
7	M-31	Spade pivot rod
8	M-32	Mulch cutter
9	M-29	Idler arm bearing, with bushing
10	M-28	Idler arm
11	M-30	Idler arm bearing bolt, with valve trip.
12	M-9	Spacing adjustment washers
13	M-26A	Frame holder bearing (2 needed) - with shim

NOTE: M-25 Complete spade holder assembly

Includes:

1 - M-26	1 - M-30	1 - M-97
1 - M-27	2 - M-31	2 - M-98
1 - M-28	2 - M-31A	M-9
1 - M-29	1 - M-32	(Number needed varies)

Plus 1 set of spades - (designate size and number)

NOT SHOWN

M-10P	Plastic insert, with bracket, for M-10 spade.
M-60	Mulch sled
M-60A	Mulch sled, rail only.

ROTATING DISCS TO HOLD POCKET SPADES

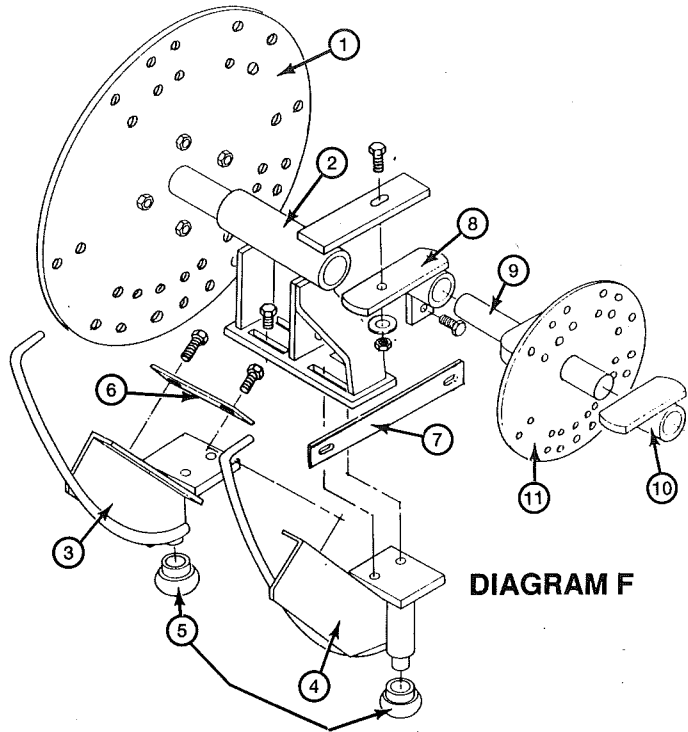

DIAGRAM F

REF NO	PART NO	DESCRIPTION
1	M-44	Support arm disc
2	M-38	Cam mounting bracket
3	M-36	Spade opening cam - Left
4	M-35	Spade opening cam - Right
5	M-101	Spade opening cam bearing only
6	M-37	Opening cam cross brace
7	M-39	Support base
8	M-40	Idler support bracket
9	M-42	Idler disc shaft
10	M-43	Disc shaft mounting
11	M-41	Idler disc

NOT SHOWN

M-59	Front stand
1265AF	3 pt hitch
1265TB	tool bar hitch
1265BM	3 pt hitch with barrel mounting
1265BMO	3 pt offset hitch with barrel mounting
P-129-D	1 pair mounting brackets
FG	1 pair fiberglass seats, with brackets
CUS	1 pair cushion seats, with brackets

SPADE SIZES

The 1265 Holland Pot Planter comes with 3 to 8 spade holders, depending upon planting spacing. However, there are a number of different sized spades available to accept your own particular size pots. The "spade holders" will accept any of the following sized pocket spades:

SPADE NUMBER	CELL OR POT SIZE	POT SHAPE	SPADE NUMBER	CELL OR POT SIZE	POT SHAPE
M-10	3/4"	Round or Sq.	M-12	1-1/2"-2"	Square
M-10A	1"-1-1/2"	Round or Sq.	M-13	1-3/4"-2-1/2"	Square
M-11	1-1/2"-2"	Round or Jiffy 7	M-14	1-3/4"-2-1/2"	Round
			M-15	2-1/2"-3-1/4"	Rnd. or Sq.
			M-16	4"	Rnd. or Sq.

CHANGING POCKET SPADES

Remove present two part spade by first removing mulch cutter (8). Disconnect springs from top of spade. Insert punch into holes in back of holder frame (4) and tap out the pivot rods (7). CAUTION. Make sure you "catch" the spacing adjustment washers which are located between the holder frame and the pivot rod sleeves, attached to the pocket spade. Put new spade in using reverse order. IMPORTANT ADJUSTMENT. Make sure you use both adjustment screws and the spacing washers to "center" the spade in the holder frame. The spade must be centered from side to side within the holder, and bottom edges must be lined up and also flush with each other to get the right planting action. M-10 and M-10A spades use the inner set of holes, all other spades use the outside set of holes.

MAINTAINING A BALANCE

The rotating discs (1 and 11, diagram F) on your 1265 Mulch Planter must always remain "in balance". Check chart below for correct number of spade holders required to get the distance between plants that you need. However, remember a minimum of 3 or 4 arms and holder frames are required to keep the planter running smooth and "in balance", and will help cushion any shock should you run into a rock or other hidden object which could otherwise cause damage. i. e. 42" and 84" spacing must have a minimum of 4 arms and holder frames.

PLANT SPACING CHART

	Distance wanted between plants.										
	10 1/2"	12"	14"	17"	21"	24"	28"	34"	42"	56"	84"
No. of spade holders needed	8*	7**	6***	5	4	7	3	5	4	3	4
Location of spades											

You pick the spacing you want. We will attach spades to the disc to match the distance you request, per the drawings shown above.

*The 8 holder machine is a special order, available only with M-10 or M-10A spades.
 **Not available with M-15 or M-16 spades.
 *** Not available with M-16 spades.