

ITEM	PART NO.	DESCRIPTION	QTY.	SIZE	UNITS
1	4217	Screw M8 x 20	1		EACH
2	5160	Washer M8 Flat	1		EACH
3	5399	SCREW: S17 Ng.6x3/8" FZ PAN HD. B	2		EACH
4	5472	SCREW M6 x 16 SET. HEX	4		EACH
5	5722	WASHER M6	13		EACH
6	5971	SCREW M6 x 25 HEX	1		EACH
7	5984	NUT. M6 NYLOC	5		EACH
8	5994	WASHER (FORM 'A'), M16 FLAT, SIS	1		EACH
9	5995	NUT. M16 NYLOC. A4 SIS	1		EACH
10	7138	CRIMP SPLICE. 1.5-2.5mm. HEAT SHRINKABLE	2		EACH
11	7699	GREASE NIPTLE - 1/8" BSP - STRAIGHT	2		EACH
12	9069	CHASSIS ARM	1		EACH
13	9070	PIVOT ARM	1		EACH
14	9071	CHASSIS ARM LH FRONT GUARD	1		SQ.MTRS
15	9072	CHASSIS ARM REAR GUARD	1		SQ.MTRS
16	9073	PIVOT ARM GUARD	1		EACH
17	9074.00	PIVOT ARM GUARD ( MAT'L C35 )	1		EACH
18	9083	Ø 16 THREADED SHAFT ( MAT'L C35 )	4		EACH
19	9106	SELF LUBRICATING BEARING - ID16 x OD20 x 20LG	4		EACH
20	9232	HEX HEAD FLANGE SCREW (DIN 6921). M8x10. & 8. ZN P.L.T.	6		EACH
21	11414	M5 x 10	1		EACH
22	11753	VALVE. SOLENOID. 12VDC. NC WITHOUT BYPASS	1		EACH
23	AD014	SOLENOID BRYKT (BREAKAWAY)	2		EACH
24	AD014	ADAPTER. 1/8 BSP x 6 mm	1	0.50	METRES
25	AD022	6 mm Micro Hose	3		EACH
26	GE001	SADDLE CLAMP 16 mm	1		EACH
27	GS014	Twin Cable Red/Black LINCHPIN 1/4" (6mm)	1	.050	METRES
28	GE037	16mm Black Conduit	1	0.25	METRES
29	IE005	TENSION SPRING. 2.5mm. ZINC PLATED	1		EACH
30	UF046	POP RIVET. 73AS 4-8	1		EACH
31	ZE008	CONNECTOR. 3 WAY	1		EACH
32	ZU005	Pivot Connector II	1		EACH

ZONE	REV.	DESCRIPTION	DATE	AMENDED BY	CHECKED BY

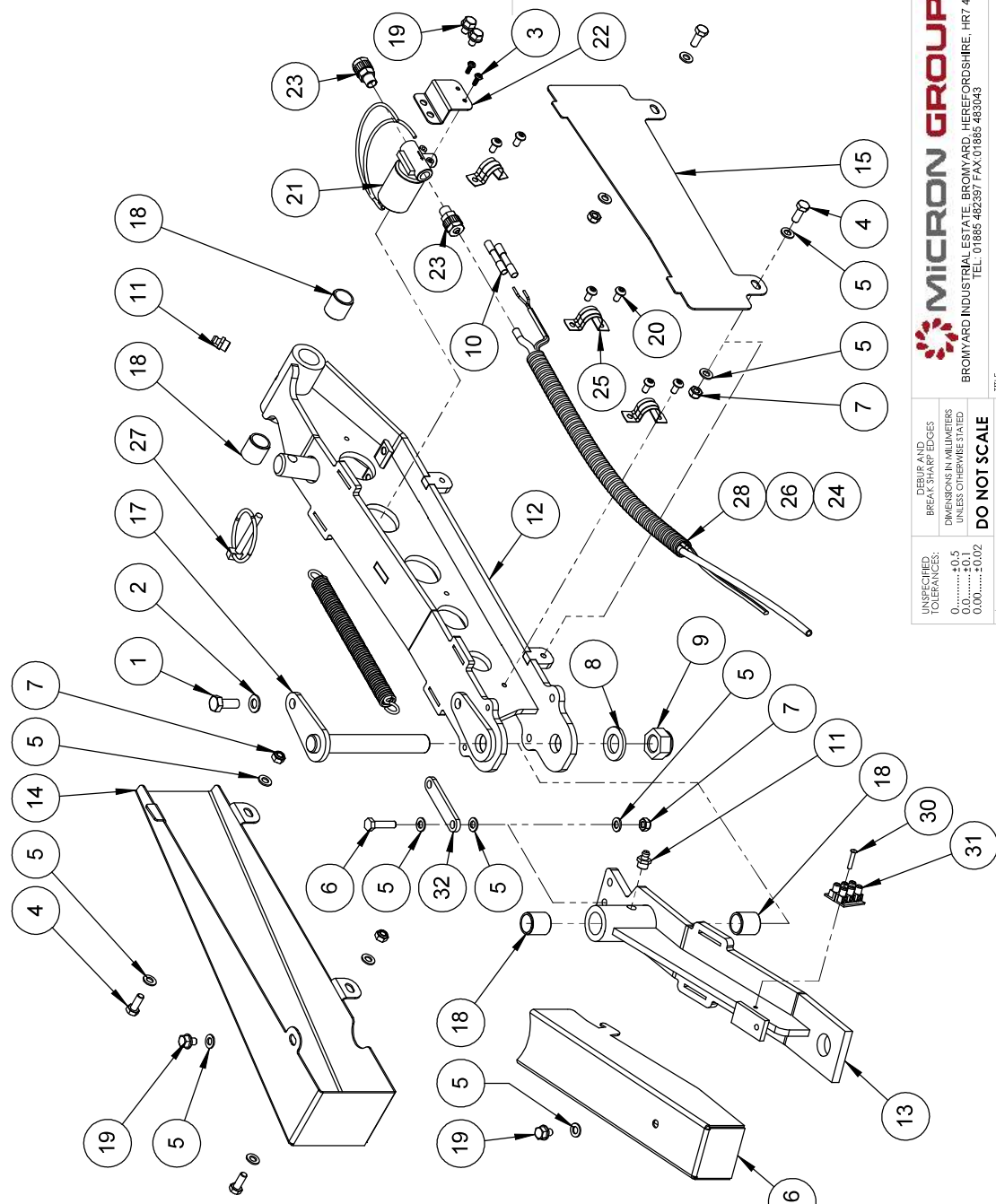

**MICRON GROUP**  
 BROMYARD INDUSTRIAL ESTATE, BROMYARD, HEREFORDSHIRE, HR7 4HS  
 TEL: 01885 482397 FAX: 01885 483043

TITLE: **BREAKAWAY ASSEMBLY LH, ORCHARD SPECIAL**

UNSPECIFIED TOLERANCES:  
 0.....±0.5  
 0.00.....±0.02  
**DO NOT SCALE**

DEBUR AND BREAK SHARP EDGES  
 DIMENSIONS IN MILLIMETERS  
 UNLESS OTHERWISE STATED

THIRD ANGLE PROJECTION

DRAWN BY: **M BOTFIELD** DATE: **01/11/2018**

MATERIAL: **11711**

FINISH: **ENVIROMIST**

PART NO. **11711**

PROJECT **ENVIROMIST**

REVISION **1**

WEIGHT: 5929.3

SCALE: 1:4

SIZE: A3

SHEET 1 OF 1