

REVISIONS			
ZONE	REV.	DESCRIPTION	CHECKED BY
	2	New Tank and changes to assembly structure	MAB

**MICRON GROUP**  
 BROMYARD INDUSTRIAL ESTATE, BROMYARD, HEREFORDSHIRE, HR7 4HS  
 TEL: 01885 482397 FAX: 01885 483043

TITLE: **SD1524 VINEYARD SPECIAL TOWED COMPLETE**

DO NOT SCALE  
 THIRD ANGLE PROJECTION  
 DRAWN BY: **M BOTFIELD** DATE: **13/03/2018**  
 MATERIAL:   
 FINISH:   
 WEIGHT: 552271.3  
 SCALE: 1:25 SIZE: A3 SHEET 1 OF 2

PART NO. **AA905**  
 PROJECT **ENVIROMIST**  
 REVISION **02**

REVISIONS			
ZONE	REV.	DESCRIPTION	CHECKED BY
	2	New Tank and changes to assembly structure	MAB

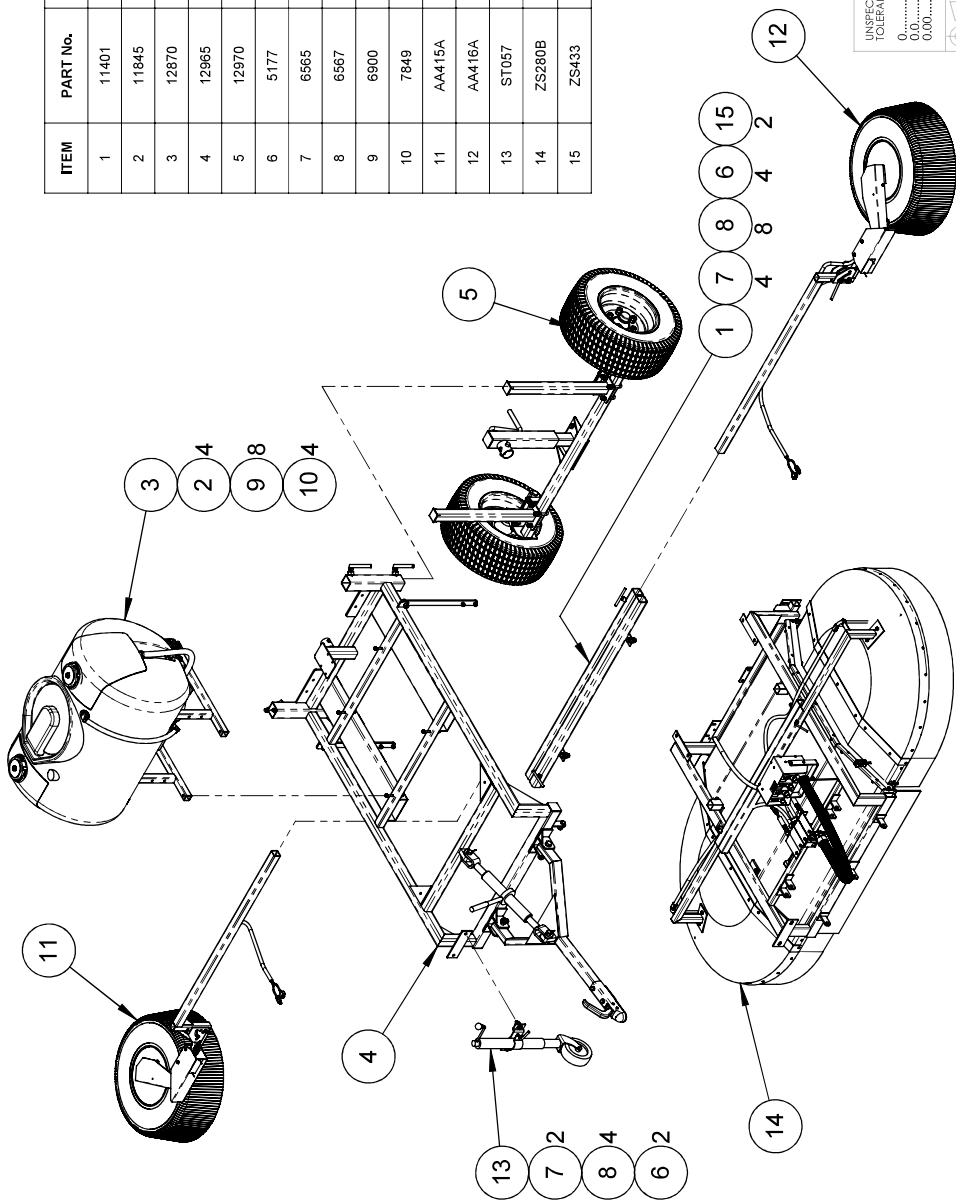

ITEM	PART No.	DESCRIPTION	QTY.
1	11401	SLIDE TUBES, OUTER	1
2	11845	BOLT, M8 x 100 HEX. A2 (SIS)	4
3	12870	ASSEMBLY, 200L TANK SYSTEM WITH HANDWASH AND RINSE	1
4	12965	ASSEMBLY, ADJUSTABLE SPRAYDOME OVERFRAME	1
5	12970	ASSEMBLY, ADJUSTABLE SPRAYDOME OVERFRAME 1524	1
6	5177	NUT, M12 NYLOC	6
7	6565	SCREW M12x40	6
8	6567	WASHER, M12 FLAT	12
9	6900	WASHER, M8	8
10	7849	NUT, M8, NYLOC, SIS	4
11	AA415A	UNDAVINA XT 600 RH FOR VINEYARD SPECIAL	1
12	AA416A	UNDAVINA XT 600 LH FOR VINEYARD SPECIAL	1
13	ST057	JOCKEY WHEEL, 6 X 2, c/w CLAMP	1
14	ZS280B	SD 1524 BODY c/w 4 WAY CONTROL BOX	1
15	ZS433	CLAMP BOLT 1/2" BSW	2



BROMYARD INDUSTRIAL ESTATE, BROMYARD, HEREFORDSHIRE, HR7 4HS  
TEL: 01885 482397 FAX: 01885 483043

TITLE: SD1524 VINEYARD SPECIAL  
TOWED COMPLETE

UNSPECIFIED TOLERANCES:  
0.0.....±0.5  
0.00.....±0.02

DEBIS AND BREAK SHARP EDGES DIMENSIONS IN MILLIMETERS UNLESS OTHERWISE STATED

DO NOT SCALE

THIRD ANGLE PROJECTION

DRAWN BY: M BOTFIELD  
DATE: 13/03/2018

MATERIAL:  
FINISH:

WEIGHT: 562271.3

PART NO. AA905  
PROJECT ENVIROMIST

SCALE: 1:25  
SIZE: A3

REVISION 02

SHEET 2 OF 2