

CONTENTS

Centre Row Sprayer Product Range	2
Spraydome Installation Procedure	3
Spraymiser Installation Procedure	4
Pre-Operation Checking Procedure	5
Operating Procedures	6-7
Parts, Drawings & Photos	
- Adjustable Spraydomes	8-9
- Spraymisers	10-11
Spraydome Application Rates	12
Spraymiser Application Rates	13

CENTRE ROW SPRAYER PRODUCT RANGE



Spraydome 1524



Spraymiser 1200



**Spraydome 1524
3 point version**



**Spraymiser 2000
&
Spraymiser 1800
(winged versions)**



Spraydome 2034



**Spraydome 3049
with Spraydome 1200's**



SPRAYDOME INSTALLATION PROCEDURE

1. Remove the Spraydome® from its packaging and place on a work area, taking care not to damage the CDA head/s beneath the sprayer cover.

2. Remove the WARRANTY CARD from the sprayer, fill out the relevant information and post it back to Enviromist or your national distributor to ensure full warranty.

FOR TOWED SPRAYERS:

3. You will need to adjust the towbar to the desired length. There are holes on the inner tube that allow for extension of the draw bar.

4. Position the sprayer close to the vehicle's tow position then adjust height of drawbar to suit vehicle by loosening bolts on the adjustment assembly underneath the drawbar. Height should be set to ensure that the bottom of the brush is above the ground to be sprayed by 20-50mm (1-2")

5. Remove the pin from the end of the drawbar and position over the vehicle tow point. Insert tow pin and secure with lynch pin.

6. Refer to "Backplate installation Procedure" regarding instructions for connection of the sprayers control box to the backplate.

7. Set spray width by sliding the side "wings" on top of the sprayer shroud to the desired width and then lock in place with the clamp bolt supplied.

FOR 3 POINT LINKAGE SPRAYERS:

8. Position linkage sprayer so that tractor can back up to the "A" frame of the sprayer.

9. Remove lynch pins from lower linkage pins and remove top locating pin.

10. Position tractor and connect lower pins and tractor top link.

11. Attach the hose from the tank into the backplate and connect the power wire.

12. Refer to "Tank—Backplate Connection Procedure" for instructions on how to connect sprayers control boxes to the backplate.

13. Set spray width by sliding the side "wings" on top of the sprayer shroud to the desired width and then lock in place with the clamp bolt supplied.

SPRAYMISER INSTALLATION PROCEDURE

1. Remove the sprayer from its packaging and place on a work area, taking care not to damage the CDA head/s beneath the sprayer cover.
2. Remove the WARRANTY CARD from the sprayer. Fill out the relevant information and post it back to Enviromist industries or your national distributor to ensure full warranty.
3. Four Wheel ATV Mounting.
Most Spraymiser mounted to ATV's are mounted using the optional ATV mount which has a stock code of ZS026 (Fig 5 No.1). (Alternatively the mount tube may be welded to a suitable customer supplied frame to suit intended use).
Fix the base of the ZS026 to the hitch plate of the ATV using a suitable sized bolt and nut. Slide the vertical tube on the sprayer into the tube on the ATV mount and secure with the clamp bolts (Fig 5 No.2). Ensure that the bottom of the sprayer is clear of the ground. Connect Control Box to Back Plate as described in step 6 of "Backplate Installation Procedure"

4. Tractor Boom Mounting
Fabricate suitable boom and mounts to suit Mount Tube if that is to be used as the mounting point.
Slide the vertical tube on the sprayer into the mount tube and secure with the clamp bolts. Ensure that the bottom of the sprayer is clear of the ground.
Connect Control Boxes to Back Plate/s as described in step 6 of "Backplate Installation Procedure".

IMPORTANT

The bottom of the shroud should clear the top of the target to be sprayed by approximately 50mm (2"), ensuring the CDA head is clear of any ground interference.

If the shroud is set too high, the risk of spray drift increases dramatically.

If the shroud is set too low, debris may interfere with CDA operation, and hitting the ground or obstructions may damage the CDA.

1. Before attempting to use any Enviromist equipment, READ the Operators manual thoroughly.

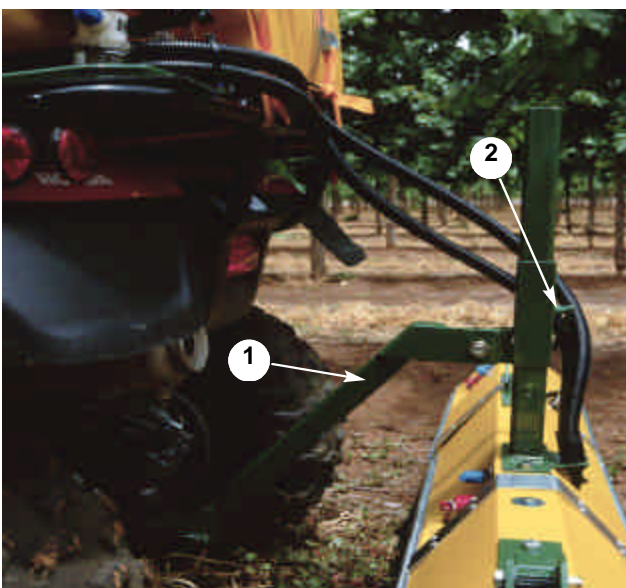

Fig 5



Spraymiser mounted to 4 wheel motorbike

PRE-OPERATION CHECKING PROCEDURE

2. Read and follow instructions on chemical manufacturer's labels.
3. Always wear applicable protective clothing.
4. Check that all maintenance procedures have been followed.

Before filling the sprayer tank with chemical mixture, it is recommended that you complete the following test procedures to check that the system is working properly.

5. Check all plumbing and fittings to ensure that all connections are correctly coupled and there is no damage or leaks.
6. Check that tank, strainers, lines and nozzles are clean.

WARNING: USE CLEAN WATER ONLY for the balance of this procedure. DO NOT use chemical mixture when checking the sprayer.

7. Place a small amount of clean rainwater in the clean, empty chemical mixture tank, ensuring the strainer is in place when filling. Failure to use the strainer will increase the likelihood of system blockages from contaminated water. The smaller fresh water flushing tank should also be filled at this point if one is incorporated in the system.

8. Turn the Control Unit switch(es) switch (Fig 2, No.11) **ON**.

At this stage the pump should start and the liquid flow will purge all air from the system liquid lines. Refer to the instructions printed on the tank if a fresh water flushing system is in use.

9. Check that the CDA beneath the shroud is working correctly. The disc of the CDA should be spinning counter clockwise when viewed from below and should be spreading

a very fine mist. If not, refer to the TROUBLE SHOOTING section within this manual.

10. The reading on each flowmeter should be 10-12 litres per hour (2.6 - 3.2 US Gallons per hour)

11. The sprayer is now ready for field operations.

OPERATING PROCEDURES

1. Establish the rate of chemical to be applied using the chemical manufacturer's recommendations.
2. Calculate the correct amount of chemical to add using the procedures in the pages **HOW TO CALCULATE APPLICATION RATES**.
3. Check the sprayer control switch(es) is **OFF** (Refer page 10, Fig.2, No. 11 from main manual).
4. Mix water and chemical thoroughly and then add mixture to the tank.

IN FIELD ADJUSTMENTS

Before starting operations, the width and height of the applicator must be adjusted to suit your conditions.

ADJUST WIDTH of Undavina(s)[®] or Spraydome(s)[®] to suit operation.

When striking the butt of a vine or tree **ENSURE THAT THE SPRING ARM MECHANISM IS NOT EXCESSIVELY USED.**

The trunk of the tree or vine should strike approximately between the 2 and 3 o'clock position looking down on the top of the right hand Undavina[®] or Spraydome[®]. The flexible disc under the Undavina[®] cover should hardly touch the trunk of the tree or vine.



The trunk of the tree or vine should not be pushed more than 100mm (4") into the cover from its perimeter when passing. This will give a smooth operation and deflection and therefore extend the life of the machine.

If an operating head cover is set to greater than 100mm (4") overlap it will cause excessive movement and constant hammering on the pivot arm stop which will lead to excessive wear and tear.

5. HEIGHT ADJUSTMENT

On all units, set the height of the shroud to clear the top of the spray target by approximately 50mm (2").

The ends of the skirt or dome should not touch the ground, random high grass will pass through or under the unit.



OPERATING PROCEDURES *contd*

WARNING: If a Spraydome® is set too low, constant contact between the dome and the ground or high grass may result in permanent deformity of the dome.

WARNING: Continued scuffing against the wheel of the operating vehicle may cause irreparable damage to a cover or dome.

WARNING: If the Undavina® is set too low the skirt will foul with the ground or vegetation. This will open the protective skirt of the Undavina® and may cause unnecessary drift or interfere with the spray pattern and return a variable result.

6. OPERATION

To operate the sprayer, turn the Inline Switch **ON** (Refer page 10, Fig.2, No. 5 from main manual), then control switches **ON** (Refer page 10, Fig.2, No. 11 from main manual) as required, then travel at the speed determined for your application rate.

It is recommended that the vehicle speed with Enviromist equipment should not exceed 10kph (6mph).

When turning at the end of rows the sprayer(s) may be turned OFF and ON as required using the Inline Switch (Refer page 10, Fig.2, No. 5 from main manual). If it is required that heads be turned off independently then the chemical supply line for that head must be disconnected at the Back Plate while the pump is not operating. Other options to turn heads off independently are available if required. Your dealer will be able to advise you these options.

7. FLOW INDICATOR

The ball in the flowmeter (Fig.7, No.1) on the Control Unit not only indicates

to the operator that the sprayer is working but gives a reasonably accurate indication of the flow rate to that operating head. (see note below).



If the ball drops while operating **something is wrong** and the chemical is not being applied as required. If this happens while spraying **stop the unit** and rectify the problem before attempting to spray again.

Refer to the **TROUBLE SHOOTING** section in main manual for additional information.

Note: The flow meter is calibrated using water only and is accurate. As the concentration of chemical increases the flow rate may vary slightly from what is indicated, but in most cases there is no need to take this variation into account.

Note: When the pump is first switched on the indicator will fluctuate wildly, this is caused by air and water passing intermittently through the meter and the jet. Once the air is out of the line the indicator will settle down.

SPRAYDOME PARTS IDENTIFICATION

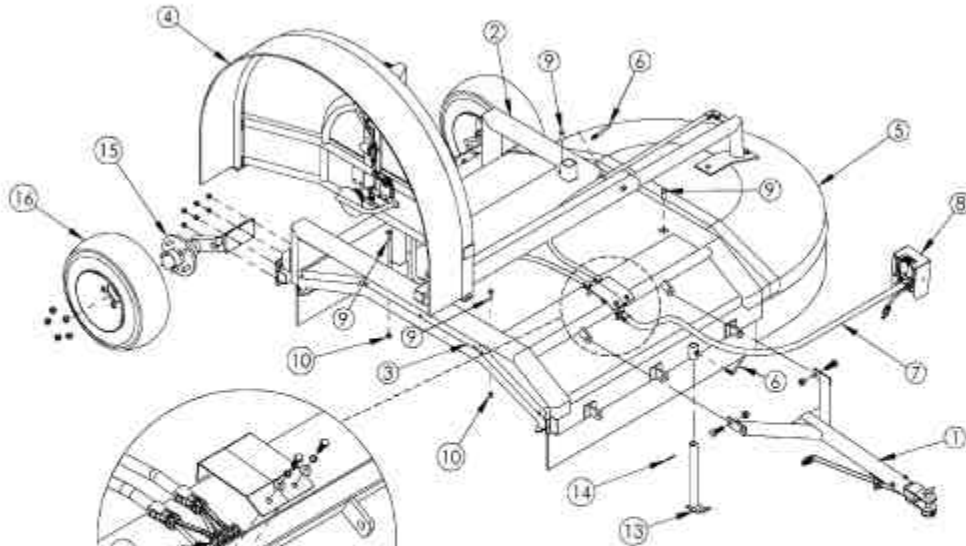

ITEM NO.	PART NO.	DESCRIPTION
1	AA 199	Tow Bar Assembly Complete
2	ZS250	Main frame for Adjustable sprayer
3	ZS251	Centre Section for SD15/24
4	ZS252	R/H Wing for SD 15/24
5	ZS253	L/H Wing for SD15/24
6	ZU015	Clamp Bolt
7	ZS205	4.0m Hose & Cable Assy
8	AA247	Twin Control Box 30 Lph
9	UF018	3/8BSW x 1 ZC Hex Set Screw
10	LF029	3/8UNC ZC Nyloc Nut
11	GE034	20mm Straight Fitting
12	ZE006	5 Way Connector
13	ZS296	SD15/24 Support Leg
14	UF001	32 x 3.2 ZP Cotter pin
15	ZS281	Std Suspension c/w Axle & Hub to suit Adj Spraydome
16	ZS282	Tyre & Rim - Adjustable Spraydome

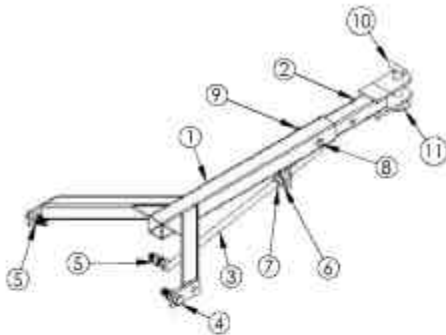

ITEM NO.	PART NO.	DESCRIPTION
1	ZS239	Tow Bar - Body
2	ZS003	Tow Bar - Inner
3	ZS240	Tow Bar - Adjustment Assembly
4	UF037	UF037 1.2BSWx1-1.2 ZC Bolt
5	UF030	UF030 1.2BSW ZC Nyloc Nut
6	UF007	UF007 1.2x1-1.4 ZP Flat Washer
7	UF032	UF032 1.2 BSW Nut
8	UF022	UF022 3-8 x 2-1.2 Bolt
9	UF029	UF029 3-8BSW ZC Nyloc Nut
10	ZS002	Tow Pin
11	GS014	GS014 1-4 B2 Lynch Pin

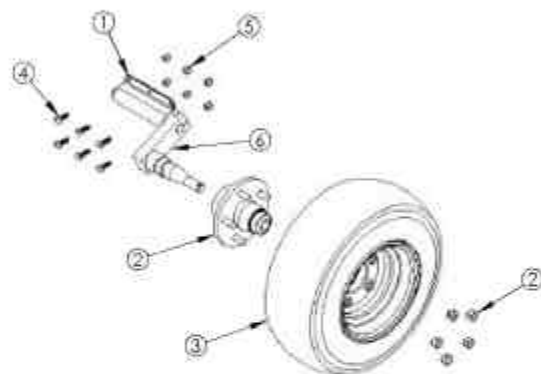

ITEM NO.	PART NO.	DESCRIPTION
1	ST040	Flexiride No.2 Body ONLY
1	ZS281	15-25 Suspension Assy RH
2	MW001	HT Hub
3	ZS266	Tyre & Rim Assy.
4	UF041	UF0 5-16BSWx 1 Bolt
5	UF052	UF0 5-16BSW ZC Nyloc Nut

SPRAYDOME PARTS IDENTIFICATION *contd*

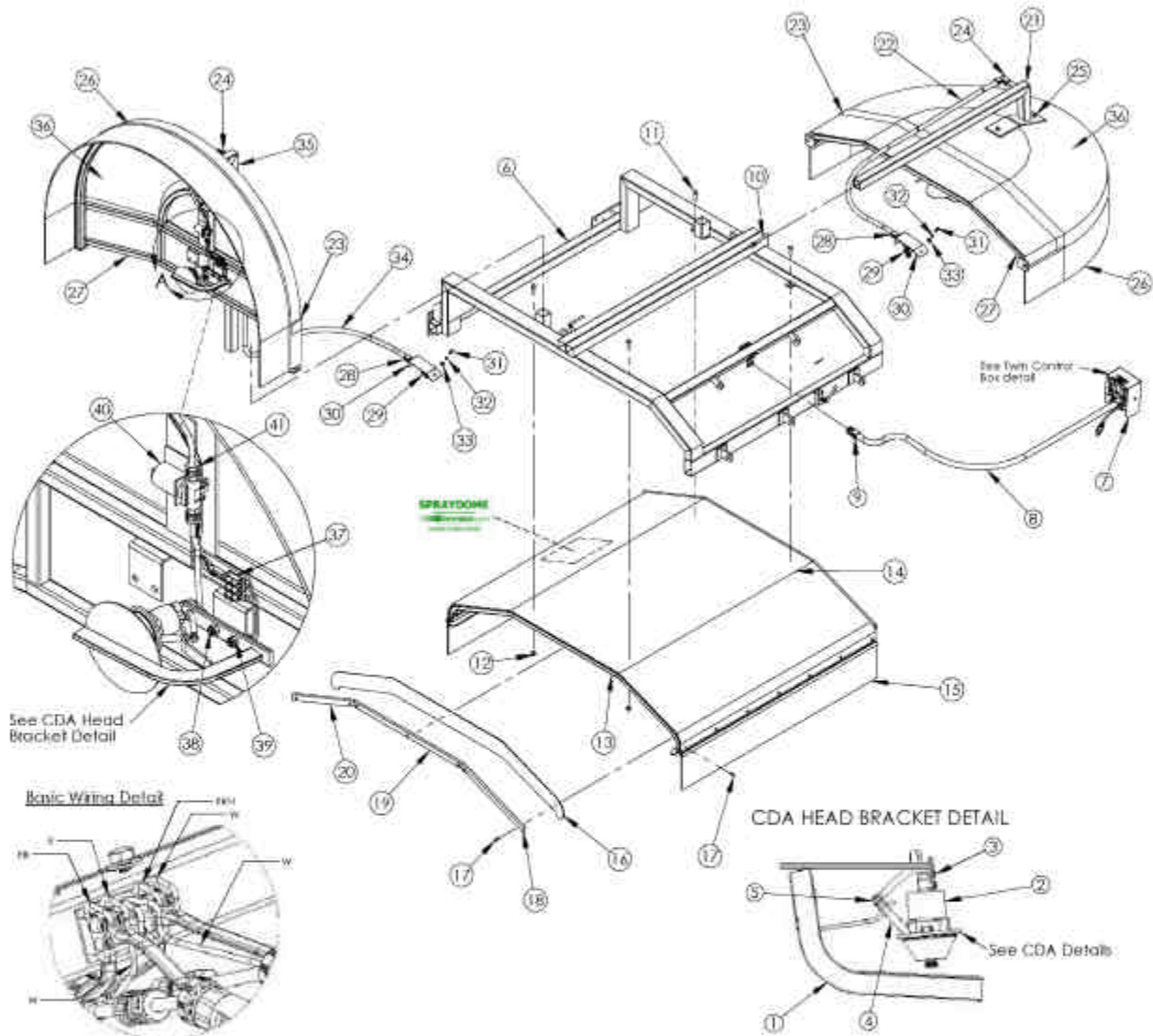

ITEM NO.	PART NO.	DESCRIPTION	ITEM NO.	PART NO.	DESCRIPTION
1	ZS202	Head bracket adjustable sprayers	22	ZS265L/5	15/24 LH Wing Hose & Cable
2	ZD004	CDA Head Complete - Ultra	23	ZS327/0 180	Modular PolyCover x 180mm
3	UF010	4ABx1/2 G304 SS Pan S/Tapper	24	GE052	Adaptaflex 90 Degree Elbow
4	MI013	Ultra + Feed Nozzle- Blue	25	UF021	3/8BSWx2 ZC Hex Set Screw
5	ZU023	Elbow - EB4 Cut	26	ZS260	Brush + Alum for SD 15/24 - wing
6	ZS250	Main Frame for Adj sprayer	27	ZS259	SD 15/24 uni wing - FRAME ONLY
7	AA247	Twin Control Box 30 Lph	28	GE098	16mm Nylon Straight Fitting
8	ZS205	4.0m Hose & Cable Assy	29	AL024	Union Connector 6mm
9	GE034	20mm Straight fitting	30	ZS264	Front Mount Plate-16mm Conduit for Adj Sprayer
10	ZU015	Clamp Bolt	31	UF016	1/4BSWx3/4 ZC Hex Set Screw
11	UF019	3/8 x 1 1/4 Bolt	32	UF004	1/4x5/8x1/8 ZP Flat Washer
12	UF029	3/8 Nyloc Nut	33	UF063	1/4x1/8x1/16 ZP Spring Washer
13	ZS256	Centre Section for SD 15/24 - FRAME ONLY	34	ZS265R/5	15/24 RH Wing Hose & Cable assembly.
14	ZS257	Poly Cover x 1.000m- Adj Spraydome of SD15/24	35	ZS263	SD 15/24 - Slide Inner RH
15	ZS241/15-24	Brush & Alum mount for 15/24	36	ZS329	0.5m Poly End Cover
16	ZS258	Rubber Seal for Adj Spraydomes	37	ZE008	5 way connector
17	UF063	73AS 6-10 Pop Rivet	38	UF045	1/4BSWx1 ZP Hex Set Screw
18	RS044/0 320	320mm Aluminium Extrusion	39	UF028	1/4UNC ZP Nyloc Nut
19	RS044/0 580	580mm Aluminium Extrusion	40	BI044	1/8" BSP 2way Solenoid with Manual Over-ride
20	RS044/0 320	320mm Aluminium Extrusion	41	AL014	1/8BSPx6mm Adaptor
21	ZS263L	SD 15/24 - Slide Inner LH			

SPRAYMISER PARTS IDENTIFICATION

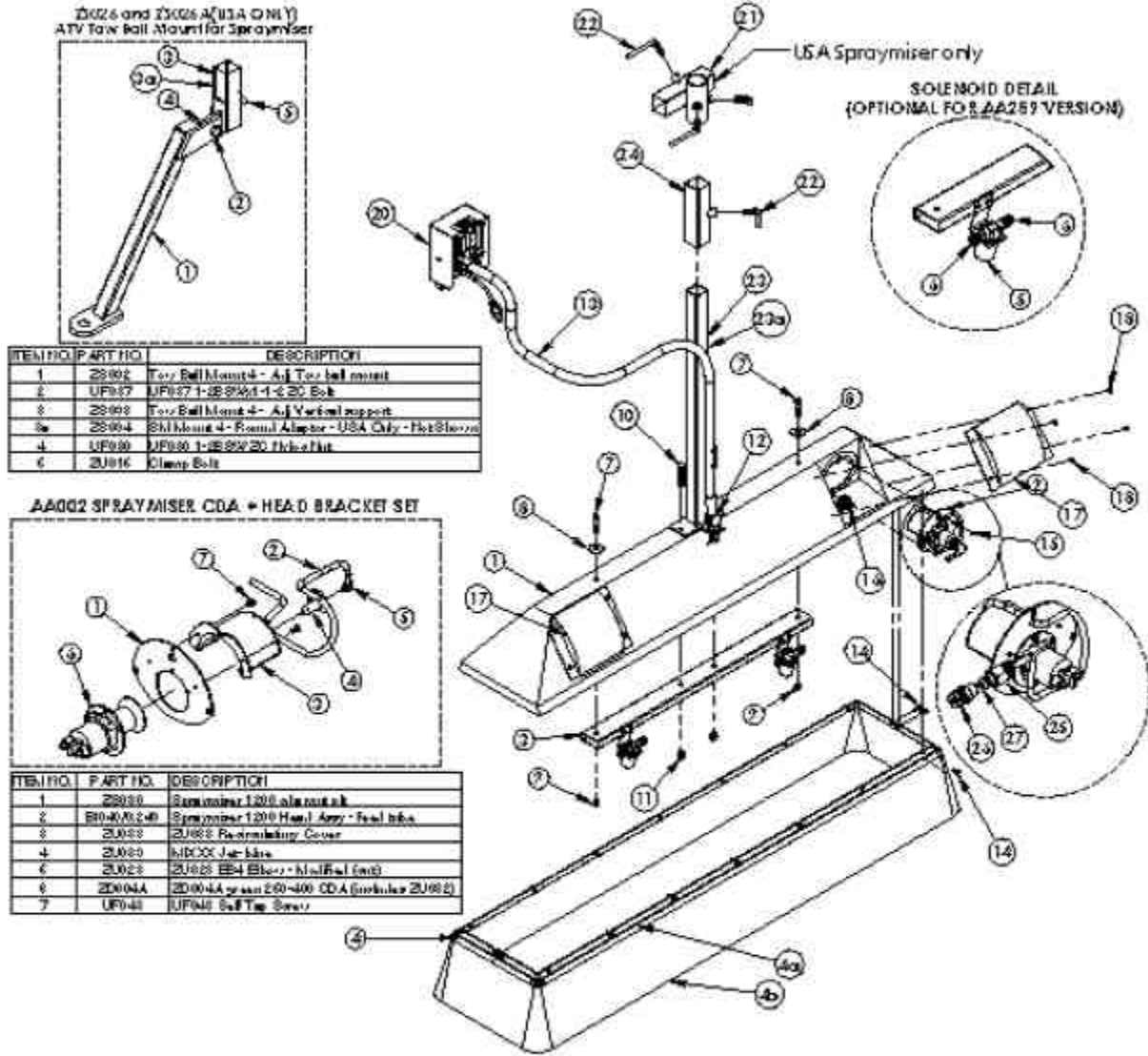

ITEM NO.	PART NO.	DESCRIPTION	ITEM NO.	PART NO.	DESCRIPTION
1	Z0007	Cover 1200 Brush recess	14	UF035	UF035 6-8 Pop Rivet
4a	Z0027	SM 1200 skirt support (Alum) - Not Shown	15	UF048	UF048 Self Tap Screw
4b	Z0028	SM 1200 rubber skirt - Not Shown	16	ZE008	ZE008 Three Way Connector
2	AA002B	Spraymiser CDA ver B Assy	17	Z0008	Spraymiser Recess Cover
3	Z0023	Vege 1200 mount Assy	23a	Z0024	SM 1200 Vertical Tube - USA Only - Not Shown
4	Z0031	Vege 1200 alumini	23	Z0077	Spraymiser V-Tube - Assy
5	B1044	B1044 Solenoid	18	UF054	UF011 10ABx3-5 Screw
6	AL014	AL014 1-8BSPx3mm Adaptor	19	UF002	UF002 3-16x1-2x20g ZP Flat Washer
7	UF017	UF017 1-4BSWx1-1-2 ZC Bolt	20	AA247	AA247 Twin Control Box
8	UF053	UF053 1-4x1-1-4x10G ZP Flat Washer	22	ZU015	Clamp Bolt
9	UF028	UF028 1-4BSW ZC Nylo-nut	21	ZV004	Rear rock uni - Vegedome mount
10	UF021	UF021 3-8 x 2 Bolt	24	Z0055	Spraymiser mount - spr unpainted
11	UF020	UF020 3-8BSW ZC Nylo-nut	25	B1027	B1027 Adaptor
12	GE034	GE034 20mm Straight Fitting - Base	26	B1028	B1028 Adaptor
13	Z0025	SM1200 unit - Conduit 20mm	27	ZU030	HN024 No 8 Restrictor

SPRAYMISER PARTS IDENTIFICATION

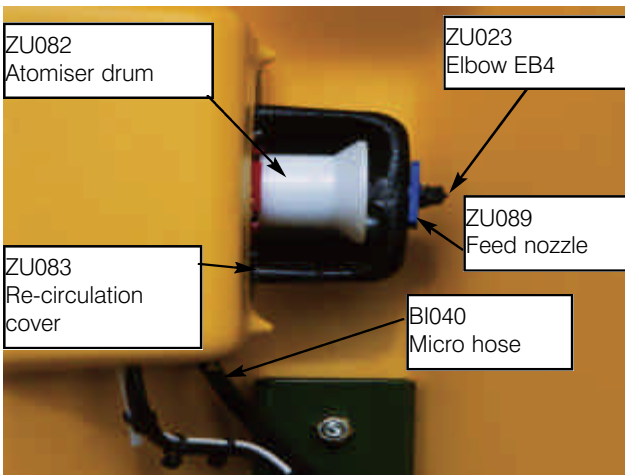
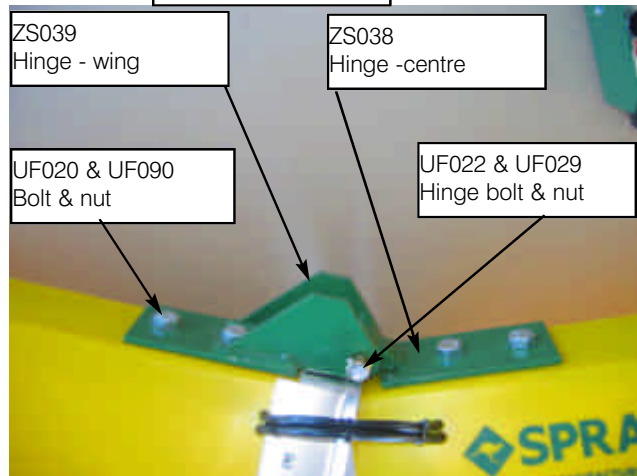
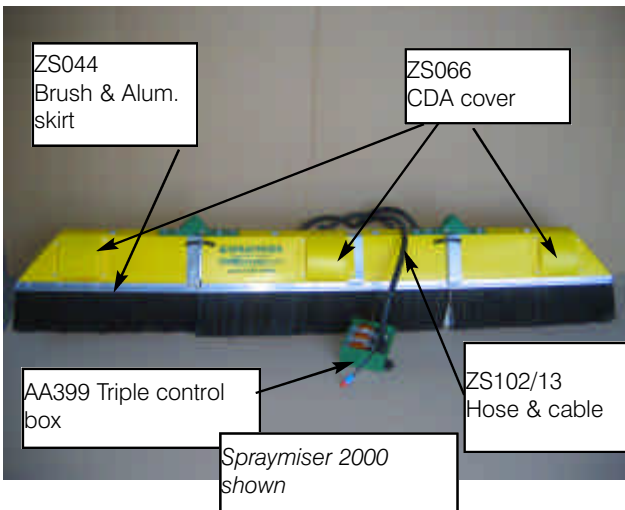
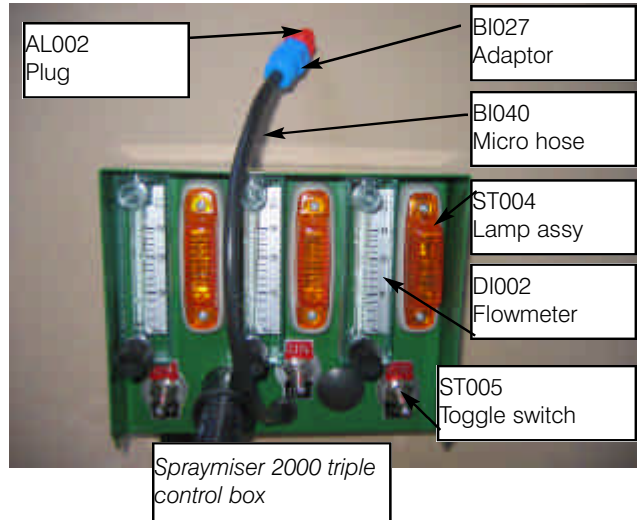
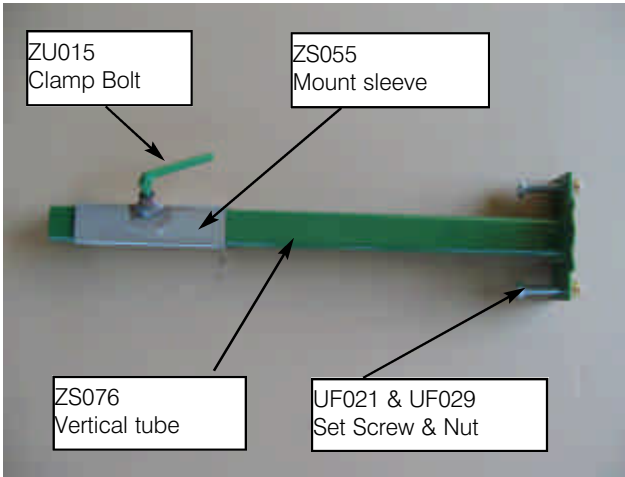

NOTE:

Spraymiser models AA259 (Spraymiser 1200) AA267 (Spraymiser 1800) and AA267B (Spraymiser 1800 with fold up wings) all have double control boxes, details of which can be found on page 19 of this manual.



ADJUSTABLE SPRAYDOMES

METRIC APPLICATION RATES

QUICK REFERENCE GUIDE - NOMINAL LITRES PER SPRAYED HECTARE

KPH	Spraydome 1524	Spraydome 2034	Spraydome 3049
10	14.3	16.1	15.0
9	15.9	17.9	16.7
8	17.9	20.1	18.8
7	20.4	23.0	21.4
6	23.8	26.8	25.0
5	28.6	32.1	30.0
4	35.7	40.1	37.5
<i>Nominal Spray Width (M)</i>	2.1	2.8	4.0
<i>Flow Rate (LPH) (total of flowmeters)</i>	30	45	60

US GALLON APPLICATION RATES

QUICK REFERENCE GUIDE - NOMINAL US GALLONS PER SPRAYED ACRE

MPH	Spraydome 1524	Spraydome 2034	Spraydome 3049
5	1.92	2.14	2.00
4.5	2.12	2.38	2.23
4	2.39	2.68	2.51
3.5	2.74	3.06	2.86
3	3.19	3.57	3.34
2.5	3.83	4.29	4.01
2	4.79	5.35	5.01
<i>Nominal Spray Width (inches)</i>	82"	110"	157"
<i>Flow Rate (USGPH) (total of flowmeters)</i>	7.9	11.9	15.9



SPRAYMISER

METRIC APPLICATION RATES

QUICK REFERENCE GUIDE NOMINAL LITRES PER SPRAYED HECTARE

KPH	Spraymiser 1200	Spraymiser 1800	Spraymiser 2000
10	18.33	18.33	16.50
9	20.37	20.37	18.33
8	22.92	22.92	20.63
7	26.19	26.19	23.57
6	30.55	30.55	27.50
5	36.66	36.66	33.00
4	45.83	45.83	41.25
<i>Nominal Spray Width (M)</i>	1.2	1.8	2.0
<i>Flow Rate (LPH) (total of flowmeters)</i>	22	33	33

US GALLON APPLICATION RATES

QUICK REFERENCE GUIDE NOMINAL US GALLONS PER SPRAYED ACRE

MPH	Spraymiser 1200	Spraymiser 1800	Spraymiser 2000
5	2.44	2.44	2.21
4.5	2.70	2.70	2.46
4	3.04	3.04	2.76
3.5	3.47	3.47	3.15
3	4.05	4.05	3.68
2.5	4.86	4.86	4.42
2	6.08	6.08	5.52
<i>Nominal Spray Width (inches)</i>	47	71	8.7
<i>Flow Rate (GPH) (total of flowmeters)</i>	5.8	8.7	11